

## DRUM DIMENSIONS AND WEIGHT

TYPE (n)	D1 (mm)	D2 (mm)	L2 (mm)	L1 (mm)	NET WEIGHT (kg)	BULK SPACE (mm <sup>3</sup> )	VOLUME (STAVED) (mm <sup>3</sup> )
06	630	315	335	410	16	0.34	0.23
07	710	355	420	495	20	0.45	0.33
08	800	400	470	545	28	0.54	0.46
09	900	450	470	565	36	0.63	0.59
10	1000	500	580	675	55	0.81	0.84
12	1250	630	630	740	85	1.09	1.42
14	1400	710	750	870	125	1.41	2.04
16	1600	900	900	1055	190	1.92	3.18
18	1800	1120	1140	1315	270	2.63	4.90
20	2000	1250	1140	1325	365	2.94	6.05
22R	2240	1300	1000	1185	450	2.96	6.80
22	2240	1400	1140	1325	480	3.28	7.54
25	2450	1500	1140	1325	600	3.58	8.98
26S	2600	1600	1140	1365	770	3.90	10.37
25S	2450	1250	1140	1325	600	3.58	8.98
25S pal	2450	1250	1270	1455	650	3.90	9.80
26S pal	2600	1250	1270	1455	800	3.56	11.00

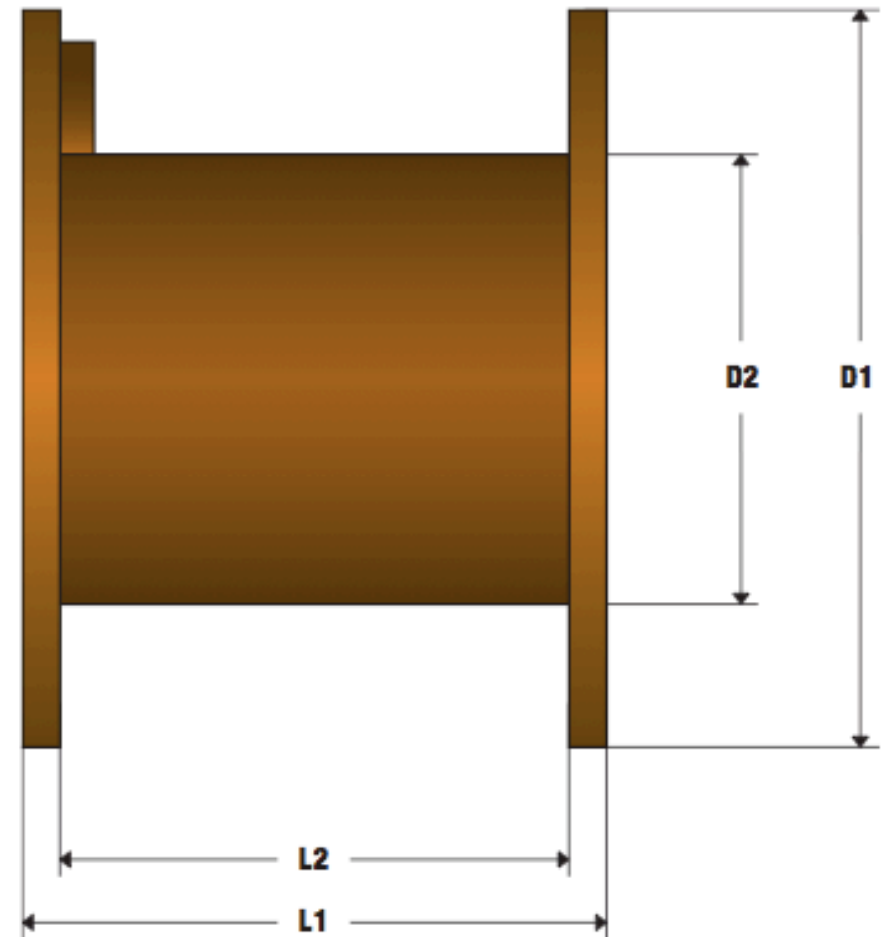

On the above table you can find our most common types of drum. For each one also we provide internal and external dimensions, weight, bulk space and volume. Please consider that a staved drum increase its dimension D1 of 5mm in total.